

NOTE:
ALTERNATE TOP SLAB FOR SHALLOW APPLICATIONS
REINFORCED TO MEET OR EXCEED REQUIREMENTS
OF AASHTO HS20-44 LOADING.

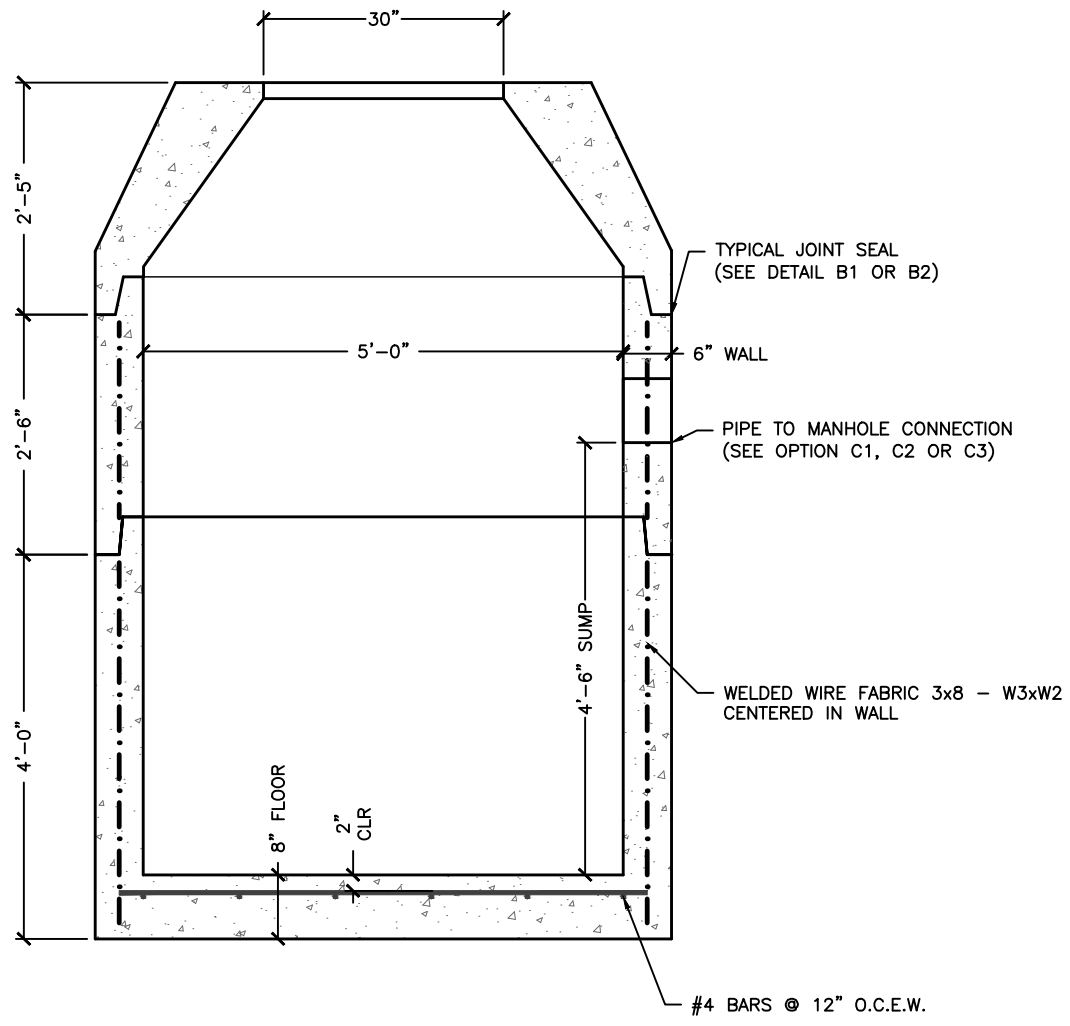

- NOTES:
1. MANUFACTURED TO MEET OR EXCEED REQUIREMENTS OF ASTM C-478 & AASHTO M-199 SPECIFICATIONS.
 2. CIRCUMFERENTIAL REINFORCEMENT SHALL CONFORM TO ASTM A-185. TOP/BOTTOM STEEL SHALL CONFORM TO ASTM A-615 GRADE 60 DEFORMED BARS. BOTH PLACED PER ASTM C-478 (8.1, 8.3, 8.4).
 3. CONCRETE: 4,000 PSI MINIMUM @ 28 DAYS, PER ASTM C-478 (6.1). CEMENT TO BE PER ASTM C-150.
 4. BUTYL RUBBER JOINT SEALANT PER ASTM C-990 & AASHTO M-198.
 5. BITUMINOUS ASPHALT COATING (IF REQUIRED) TO BE SHOP APPLIED.

MORTAR BY CONTRACTOR		B1
BUTYL RUBBER JOINT SEALANT		B2
MORTAR PIPE CONNECTION		C1
FLEXIBLE SLEEVE PIPE CONNECTION		C2
COMPRESSION GASKET		C3
ASPHALTIC COATING		D

Revised: 7/21/14

DWG NO.
S1

Customer:

Project Name:
Project Location:
**5' DIAMETER CATCH BASIN
BWSC TYPE 5**
Project No: _____ Date: _____
Designed by: _____ Drawn by: PIL _____
Checked by: XXX _____
Scale: AS SHOWN

773 BUXTON INDUSTRIAL DRIVE-PO BOX 870
HENRIKER, NH 03242
PHONE: 603-428-3218
FAX: 603-428-7426
www.michiecorp.com